

PERFORMANCE SPECIFICATIONS:

PART NUMBER	FREQUENCY RANGE (GHz)	VSWR (max.)				
		DC-2	2-4	4-8	8-12	12-18
RFT502-10	DC to 2	1.10				
RFT504-10	DC to 4	1.10	1.10			
RFT508-10	DC to 8	1.10	1.10	1.20		
RFT512-10	DC to 12	1.10	1.10	1.20	1.30	
RFT518-10	DC to 18	1.10	1.10	1.20	1.30	1.35

10 WATTS

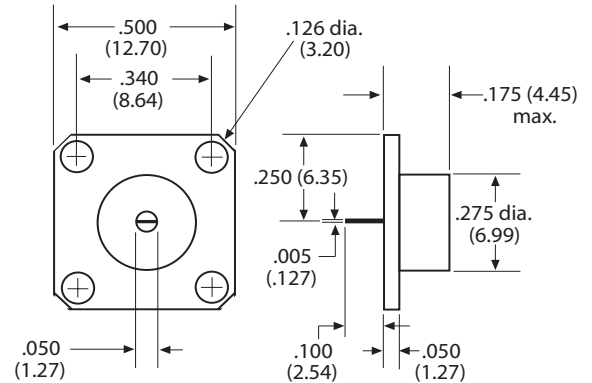

PERFORMANCE SPECIFICATIONS:

PART NUMBER	FREQUENCY RANGE (GHz)	VSWR (max.)				
		DC-2	2-4	4-8	8-12	12-18
RFT 502-X	DC to 2	1.10				
RFT 504-X	DC to 4	1.10	1.10			
RFT 508-X	DC to 8	1.10	1.10	1.20		
RFT 518-X	DC to 18	1.10	1.10	1.20	1.30	1.35

10 WATTS

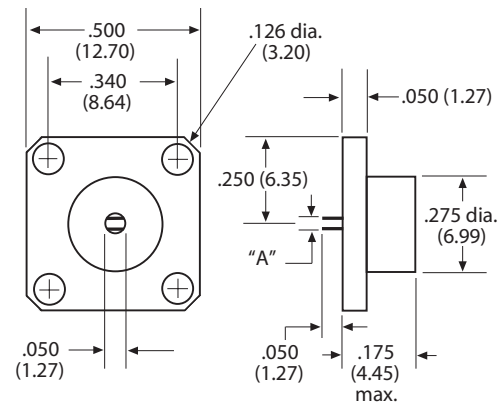

MODEL NUMBER	"A"
RFT5XX-6	.028
RFT5XX-7	.032
RFT5XX-8	.014
RFT5XX-9	.020

HOW TO ORDER BY PART NUMBER:

The part number is a combination of model, frequency range & contact type.

Example: **RFT 518 6**

MODEL NUMBER

FREQUENCY RANGE

CONTACT TYPE