

## "N" CONNECTORS

### PERFORMANCE SPECIFICATIONS:

PART NUMBER	POWER (watts)	FREQUENCY RANGE	VSWR (max.)
RCX101NF	100	DC to 2.4 GHz	1.25:1
RCX101NM			

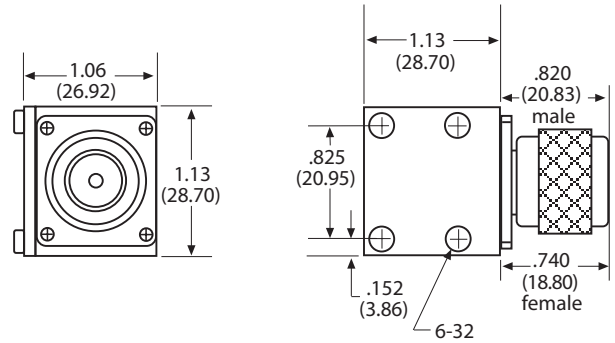

**100 WATTS (5KW peak)**

### PERFORMANCE SPECIFICATIONS:

PART NUMBER	POWER (watts)	FREQUENCY RANGE	VSWR (max.)
RCX150NF	150	DC to 1 GHz	1.10:1
RCX150NM		1 to 2 GHz	1.15:1
RCX250NF	250	DC to 1 GHz	1.10:1
RCX250NM		1 to 2 GHz	1.15:1
RCX500NF	500	DC to 1 GHz	1.10:1
RCX500NM		1 to 2 GHz	1.15:1
		2 to 3 GHz	1.30:1

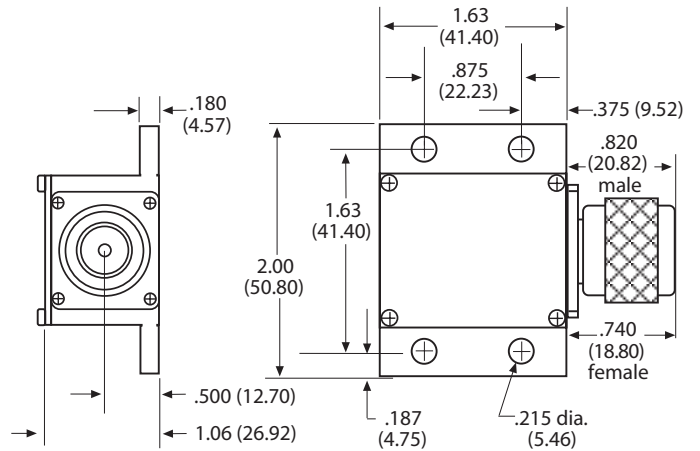

**150, 250 WATTS (5KW peak)**