

ELECTRICAL SPECIFICATIONS:

Resistance Range:

0.5-500 Ohms. For other values contact factory.

Standard Tolerance:

Resistance below 1.0 Ohms tolerance is $\pm 20\%$ at 25 °C

Resistance 1-50 Ohms tolerance is $\pm 10\%$ at 25 °C

Resistance above 50.0 Ohms tolerance is $\pm 5\%$ at 25 °C

Contact factory for other tolerance values.

Load Life: Expect maximum change in resistance to be

1% when operated at listed rating for 1000 hours.

Nominal Power:

Power rating depends on the dimension of the Disc.

See table below

Normal Frequency Range: DC to 1.0 GHz

Performance at higher frequency DC to 18 GHz depends upon how the disc is mounted and associated mounting configuration.

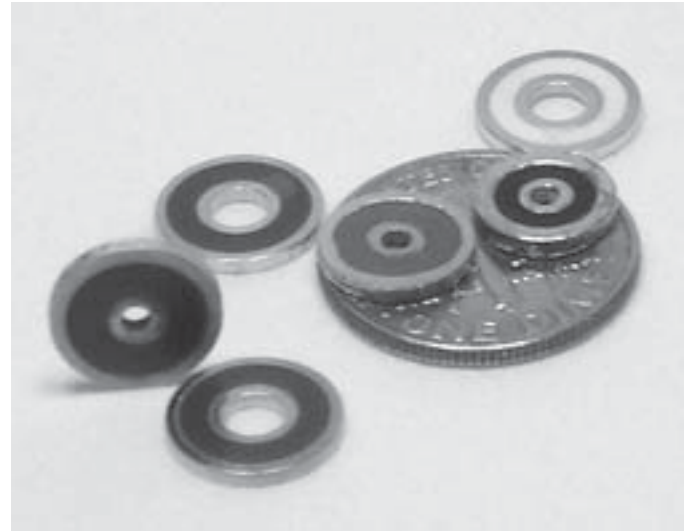

MECHANICAL SPECIFICATIONS:

Disc Material: **Beryllium Oxide** Ceramic.

Terminations:

Proprietary Silver or Tin plated terminations on both sides with a wrap around over Thick Film Conductor.

Temperature Range: -55°C to +150°C

Temperature Coefficient:

Standard Temperature coefficient is

-100 to +100 PPM/ °C

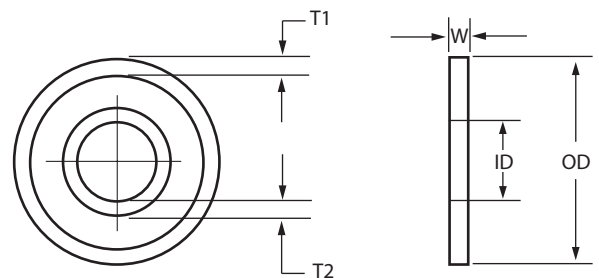

SPECIFICATIONS:

RES. (OHMS)	NOMINAL POWER	OD (inches)	ID (inches)	W (inches)	T1 (inches)	T2 (inches)
0.5 - 500	10W	0.372 - 0.380	0.131 - 0.139	0.030 - 0.036	1/32	1/32
0.5 - 500	5W	0.245 - 0.257	0.066 - 0.074	0.020 - 0.027	1/32	1/64